

VILLAGE OF WAVERLY

32 Ithaca Street, Waverly, NY 14892
607-565-8106

Permit Number _____
Tax Map ID No. _____

Property Location _____

TYPE OF PERMIT REQUESTED

- Erect
- Alter
- Repair
- Demolish
- Roof
- Fence
- Change A Use
- Sign

- New Construction
- Swimming Pool

- Permit Was:
- Approved
 - Denied
 - Other _____

- Districts:
- Industrial
 - Commercial
 - Residential
 - PUD Zoning

PROPERTY OWNER

Name _____
Address _____

Home Phone _____ Business Phone _____

Lot Size: _____ ft. x _____ ft.
Contractors: Square Footage _____
1. _____
2. _____
3. _____

COST OF IMPROVEMENTS AND REPAIRS

	Estimated Cost:	Required Fee:
General Construction	_____	1. _____
Electrical	_____	2. _____
Other	_____	3. _____
Total	_____	_____

CONTRACTORS INSURANCE

- 1. Workers Comp.
- 2. Disability Benefits
- 3. Waiver Form Completed

Site Plan

- Special Permit Required
 Yes No
 Flood Plain
 Yes, Zone Number _____
 No

CERTIFICATION

I hereby certify that I have read the instructions and examined this application and know the same to be true and correct. All provisions of laws and ordinances covering this type of work will be complied with whether specified herein or not. The granting of a permit does not presume to give authority to violate or cancel the provisions of any other state or local law regulating construction of the performance of construction.

Any building official, upon the showing of proper credentials and in the discharge of his duties may enter upon any building structure or premises at any reasonable hour and no person shall interfere with or prevent such entry.

IT IS FURTHER AGREED THAT THE PREMISES WILL NOT BE OCCUPIED UNTIL THE REQUIRED CERTIFICATE OF OCCUPANCY HAS BEEN ISSUED. PERMIT VALID FOR ONE YEAR FROM ISSUANCE.

Owner/Authorized Agent _____ Date _____

EST. Start Date _____ EST. Completion Date _____

Remarks _____

Code Enforcement Officer _____ Date _____

State of New York)

:ss.

County of Tioga)

_____, being duly sworn, according to law, deposes and says that the information in the application is true and correct.

Rear Lot Line _____ Ft.

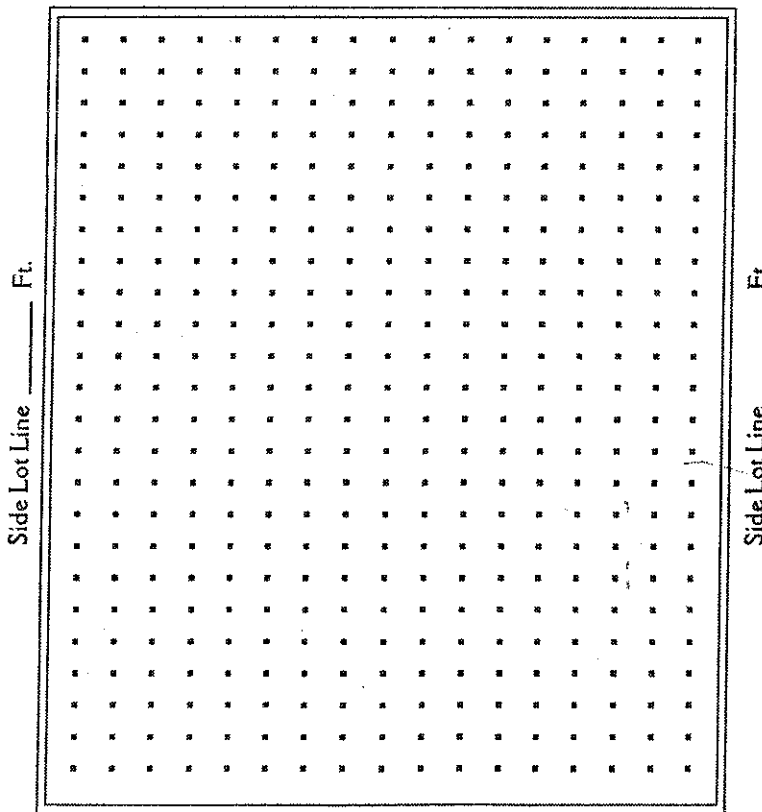

Front Lot Line _____ Ft.

Notary Signature

Sworn and subscribed before me,
A Notary Public, this _____
Day of _____, 20____

(Applicant's Signature)